

Instrument of Registration of Partial Transfer

In accordance with the provisions of Section 122 of the *Mining Act 1992*, I have registered the partial transfer of Mining Lease 1349 (Act 1992) from GLENCORE NEWPAC PTY LIMITED, ACN 115 852 438 to WHITE MINING (NSW) PTY LIMITED, ACN 089 414 595 as approved by the delegate of the Minister administering the *Mining Act 1992* on 13 December 2022.

Signed this 22nd day of December 2022



Daniel Summerhayes
Director Title Assessments
Assessments & Systems
Regional NSW – Mining, Exploration and Geoscience

as delegate for the Secretary under the *Mining Act 1992*

Delegation dated 14 October 2022.

Instrument of Approval for Partial Transfer

Pursuant to section 121(1)(a) of the *Mining Act 1992*, I, Georgina Beattie, Chief Executive Officer, Mining, Exploration and Geoscience, as a delegate of the Minister administering the *Mining Act 1992*, approves the application for partial transfer from GLENCORE NEWPAC PTY LIMITED to WHITE MINING (NSW) PTY LIMITED and determines:

1. The terms of the original authority (Mining Lease 1349 (Act 1992)) when the partial transfer takes effect will be as follows:

Holder: GLENCORE NEWPAC PTY LIMITED, ACN 115 852 438
Lease Area: An area of 1908 hectares (as shown on the attached Plan Catalogue No. M27610 (see Schedule 1 of Attachment A)
Expiry Date: 31 December 2044*
Conditions: Subject to the conditions set out in Schedule 2 of Attachment A

2. The terms of the new authority (Mining Lease 1835 (Act 1992)) when the partial transfer takes effect will be as follows:

Holder: WHITE MINING (NSW) PTY LIMITED, ACN 089 414 595
Lease Area: An area of 404.6 hectares (as shown on the attached Plan Catalogue No. M27609 (see Schedule 1 of Attachment B)
Expiry Date: 31 December 2044**
Conditions: Subject to the conditions set out in Schedule 2 of Attachment B

In accordance with Section 122(5) of the Act, the partial transfer will take effect upon the registration of this transfer. On that date:

- (a) Mining Lease 1349 (Act 1992) is taken to have been cancelled over the area part transferred, and the variations of Mining Lease 1349 (Act 1992) take effect; and
- (b) Mining Lease 1835 (Act 1992) over the part transferred area is taken to have been granted to White Mining (NSW) Pty Limited.

Signed this 13th day of December 2022



Georgina Beattie
Chief Executive Officer
Mining, Exploration and Geoscience
Regional NSW
As a delegate of the Minister administering the *Mining Act 1992*
Delegation dated: 19 October 2022

Schedule 1 – ML 1349

Description of Lease

Land: The lease area embraces all land described in the attached lease plan titled **M27610** and approved on **21 November 2022**.

Area: 1908 hectares

Surface Exception: As outlined on plan M27610

Depth Restriction: As outlined on plan M27610

Minerals: Coal

Method: Underground methods

Term ending: 31 December 2044*

* Note: Current term expires on 31 December 2023. Determined renewal term will take effect on 1 January 2024, with an expiry date of 31 December 2044.

SEE SHEET 4

PARISH OF RAVENSWORTH
COUNTY OF DURHAMPARISH OF LIDDELL
COUNTY OF DURHAM

M.G.A.



GDA 94 - M26921

SEE SHEET 3

ML149
Abt. 1908Ha
BY DEDN.

SEE SHEET 2

PARISH OF RANESWORTH
COUNTY OF DURHAMPARISH OF VANE
COUNTY OF DURHAMPARISH OF LEMINGTON
COUNTY OF HUNTERLEMINGTON ROAD
(VARIABLE WIDTH)BRUNKERS
LAKELEMINGTON ROAD
NEW ENGLAND HIGHWAY

PLAN OF PORTION ML 149

PARISH: LIDDELL, RAVENSWORTH & VANE

COUNTY: DURHAM

MAP SHEET No. 9133-3-S

REDUCTION RATIO 1:15,000

RESIDUAL OF ML 1349 (Act 1992)
RESULTING FROM PART TRANSFER / RENEWAL
DEALING NO. 38 & 35
THIS PLAN SUPERSEDES D7377

MINING DIVISION: SINGLETON

HOLDER: GLENCORE NEWPAC PTY LTD

APPLICATION TRANSFER DATE: 29-AUG-2022

STATUS:

METHOD: UNDERGROUND

SURFACE EXCEPTION / DEPTH RESTRICTION

 EMBRACES THE COAL ONLY BELOW A DEPTH OF 106.68 METRES BELOW THE SURFACE, EXCLUDING THE STRATA FROM A DEPTH OF 15 METRES ABOVE THE ROOF OF THE SEAM KNOWN IN THE DEPARTMENT OF REGIONAL NSW AS THE PIRES GULLY SEAM TO A DEPTH OF 10 METRES BELOW THE FLOOR OF THE SEAM KNOWN IN THE DEPARTMENT OF REGIONAL NSW AS THE MIDDLE LIDDELL SEAM.

 EMBRACES THE COAL ONLY BELOW A DEPTH OF 5.0 METRES BELOW THE FLOOR OF THE COAL SEAM KNOWN IN THE DEPARTMENT OF REGIONAL NSW AS THE BAYSWATER SEAM, EXCLUDING THE STRATA FROM A DEPTH OF 15 METRES ABOVE THE ROOF OF THE SEAM KNOWN IN THE DEPARTMENT OF REGIONAL NSW AS THE PIRES GULLY SEAM TO A DEPTH OF 10 METRES BELOW THE FLOOR OF THE SEAM KNOWN IN THE DEPARTMENT OF REGIONAL NSW AS THE MIDDLE LIDDELL SEAM.

 EMBRACES THE COAL ONLY BELOW A DEPTH OF 5.0 METRES BELOW THE FLOOR OF THE COAL SEAM KNOWN IN THE DEPARTMENT OF REGIONAL NSW AS THE BAYSWATER SEAM.

 EMBRACES THE COAL ONLY BELOW A DEPTH OF 106.68 METRES BELOW THE SURFACE.

 EMBRACES THE COAL ONLY BELOW A DEPTH OF 15.24 METRES BELOW THE SURFACE.

THIS LEASE IS LIMITED TO 900 METRES BELOW AUSTRALIAN HEIGHT DATUM (AHD).

NOTES:

Azimuth: M26921

Plans used in the course of this Survey/Compilation
D0769, D0876, D0886, D058, D600, D6995, D7376,
D7377, P4055, P4076, M24678, M25589, M26909,
M27209, M26921, M27205, M27606, M27607, M27609,
M27600, M27610, M27602, M27603, M27604 &
34-1557, 446-2083, 987-2577, B0202-3603, D02328,
D0247945, D0264624, D02825904, D02845360,
D02859224, D02848492, D0283086 & D02804571.
MY PLAN DATED 16/07/21..: AD. MEDIUM FILUM. AQUAE
MY PLAN DATED 22/07/18..: HERBON ROAD

Survey declared on this plan for lines

I Martin Alexander Burns
of Survey and Drafting Resources Pty.Ltd.

a surveyor registered under the Surveying and Spatial
Information Act 2002, hereby certify that the survey
represented in this plan is accurate and
has been completed in accordance with the Surveying
and Spatial Information Regulation 2017 and the
Surveyor General's Direction for Mining Surveys and
was completed on 27/10/2022

Signature :  FORM 11
BOSSI Identification No : 263

Survey Calcs :  F. Schaeff 21/11/2022Plan Investigated :  F. Schaeff 21/11/2022Plan Approved :  21/11/2022

Papers No.: PTF-2022-10 SURVEY-29, R110073770
D008242700

M27610

Papers No.: PTF-2022-10 SURVEY-29	R110073770 D006242710
-----------------------------------	--------------------------

- BEARINGS AND DISTANCES NOT SHOWN AS PLAN IS COMPILED FROM ML1349 WITH NO SUCH DATA.
- BOUNDARIES ACCURATE WITH RESPECT TO MINING LEASE ONLY.

- BEARINGS AND DISTANCES NOT SHOWN AS PLAN IS COMPILED FROM MLI349 WITH NO SUCH DATA.
- BOUNDARIES ACCURATE WITH RESPECT TO MINING LEASE ONLY.

Papers No.: PTF-2022-10 SURVEY-29 R110073770
D006248730

RM11	M27610
------	--------

CO-ORDINATE TABLE
(M.G.A. ZONE 56 GDA94)

No.	EASTING	NORTHING	No.	EASTING	NORTHING
1	314940.1	6406507.2	101	317454.0	6407852.0
2	315093.3	6406582.0	102	31616.5	6408035.7
3	315125.7	6406597.8	103	314546.2	6408262.4
4	315170.2	6406640.6	104	314759.7	6408286.1
5	315192.0	6406630.2	105	314804.5	6408200.2
6	315195.2	6407012.7	106	315068.3	6408213.9
7	315199.1	6407023.4	107	315261.6	6408102.7
8	316848.9	6407439.4	108	315444.5	6408204.8
9	316870.6	6407450.0	109	315553.1	6408227.3
10	317313.7	6407666.4	110	315690.3	6408214.9
11	317487.8	6407803.2	111	315886.3	6408171.8
12	317476.24	6407567.34	112	316089.5	6408082.3
13	317548.8	6406667.3	113	316376.7	6408005.5
14	317492.1	6406271.9	114	316513.1	6409967.2
15	317489.3	6406252.0	115	317037.0	6409946.2
16	317407.0	6405673.5	116	317039.9	6409925.9
17	317216.1	6405700.7	117	317090.5	6409945.3
18	317190.9	6405752.4	118	317127.4	6409904.6
19	316782.8	6405555.3	119	31750.7	6409017.2
20	316750.4	6405537.2	120	31753.8	6409978.0
21	316159.3	6405248.6	121	317143.5	6408804.4
22	316137.6	6405237.9	122	317164.5	6408725.4
23	315671.2	6405010.2	123	317242.6	6408462.3
24	315777.1	6405612.4	124	317286.4	6408418.3
25	315761.3	6405644.8	125	317377.4	6408349.7
26	315718.5	6405732.4	126	317375.4	6408248.8
27	315707.9	6405754.1	127	317381.3	6408132.3
28	315664.4	6406592.2	128	317379.6	6408094.5
29	315186.3	6406589.5	129	317400.5	6407947.2
30	315903.2	6406491.3	130	317418.4	6407903.9
31	315923.2	6406488.6	131	314807.2	6408220.4
32	316303.0	6406436.1	132	316033.5	6408158.1
33	316702.2	6406380.4	133	315030.3	6408192.1
34	316722.10	6406377.67	134	315127.9	6408160.9
35	316719.3	6406357.8	135	315230.1	6408135.6
36	316699.4	6406360.5	136	315328.3	6408104.0
37	316300.2	6406416.2	137	315374.7	6407920.2
38	315920.4	6406448.7	138	315389.1	6407770.0
39	315900.4	6406471.4	139	315900.9	6406748.1
40	315851.1	6406569.4	140	315617.1	6406448.2
41	315163.6	6406572.3	141	315644.7	6406227.2
42	315166.9	6405746.4	142	315797.7	6406151.6
43	315388.3	6405743.5	143	315923.5	6406124.9
44	315793.3	6405689.4	144	315972.9	64061385.0
45	315813.3	6405686.7	145	316037.3	6406123.0
46	316591.8	6405579.4	146	316149.2	6406118.9
47	316617.7	6405576.6	147	316244.9	6406109.0
48	316209.4	6405611.8	148	316393.4	6408093.3
49	316189.5	6405614.5	149	316498.5	6408075.2
50	315392.4	6405722.7	150	316559.1	6406082.6
51	315722.4	6405725.4	151	316662.4	6405788.9
52	314322.5	6406688.7	152	316715.5	6406225.6
53	314738.4	6405828.9	153	316804.8	6406148.6
54	314742.7	6405808.0	154	316886.2	6406350.4
55	314858.5	6404854.2	155	316946.4	6406269.4
56	315244.6	6404800.8	156	316982.2	6406206.8
57	315171.0	6404122.3	157	317006.1	6406156.0
58	315279.7	6404908.0	158	317019.1	6406088.0
59	315282.4	6404927.9	159	317032.4	6406090.6
60	316079.7	6404817.8	160	317034.9	6409966.4
61	316099.6	6404815.1	161	316517.0	6409987.2
62	316096.8	6404795.1	162	316382.3	6406034.8
63	316076.9	6404797.9	163	316091.3	6406102.9
64	315985.9	6403990.4	164	315886.8	6406109.1
65	315963.5	6403974.8	165	315694.1	6406232.6
66	315900.0	6403923.9	166	315580.5	6406217.6
67	315936.4	6403878.2	167	315437.9	6406225.2
68	315956.9	6403886.4	168	315257.4	6406124.8
69	315921.4	6403921.2	169	315072.2	6406104.3
70	316034.0	6403999.2	170	314667.9	6406195.8
71	316021.9	6404015.3	171	315008.3	6406177.8
72	316131.7	6404240.0	172	314956.2	6406190.4
73	316321.9	6404258.0	173	314956.4	6406201.7
74	316421.8	6404265.8	174	314542.3	6406252.1
75	316431.1	6404288.1	175	313913.9	6406208.9
76	316606.6	6404387.2	176	313875.2	6406304.6
77	316592.8	6404402.2	177	314576.0	6406208.8
78	316706.2	6404517.5	178	314628.6	6406251.2
79	316856.6	6404523.6	179	314785.5	6406207.3
80	316456.5	6404051.0	180	314735.2	6406202.2
81	316471.1	6404716.0	181	314788.1	6406227.4
82	316669.5	6404736.5	182	314624.5	6406274.8
83	316667.6	6404761.2	183	314570.0	6406229.9
84	316714.3	6405054.7	184	313785.3	6406337.1
85	316953.4	6405197.7	185	313957.7	6406197.9
86	317245.1	6405169.0	186	314455.6	6406367.4
87	317244.1	6405198.7	187	314454.1	6406371.8
88	317398.2	6405611.4	188	31436.3	6406355.0
89	314546.5	6406678.2	189	314281.9	6406260.5
90	314563.1	6406808.5	190	314257.2	6406252.4
91	314384.0	6407276.9	191	314256.6	6406272.8
92	314328.8	6407597.4	192	314224.1	6406170.2
93	314835.9	6408200.3	193	314234.2	6406168.7
94	315739.5	6408217.1	194	314262.7	6406217.8
95	315399.4	6408118.9	195	314267.3	6406251.0
96	31611.8	6408015.7	196	314291.8	6406263.1
97	316133.7	6408012.9	197	314328.5	6406255.3
98	316913.5	6407905.8	198	314264.6	6406062.6
99	316933.3	6407902.1	199	314261.1	6406024.3
100	317466.3	6407829.9	200	313952.1	6406159.9
			201	315674.3	6406106.8
			202	315662.4	6406152.2

CO-ORDINATE TABLE
(M.G.A. ZONE 56 GDA2020)

No.	EASTING	NORTHING	No.	EASTING	NORTHING
1	314940.6	6406508.6	101	317454.5	6407853.4
2	315093.8	6406583.4	102	31617.0	6408037.1
3	315126.2	6406599.2	103	314546.7	6408263.8
4	315170.7	6406642.0	104	314755.2	6408272.5
5	315192.5	6406631.6	105	314805.0	6408201.6
6	315195.7	6407014.1	106	315068.8	6408215.3
7	315199.7	6407024.8	107	315262.1	6408104.1
8	316849.4	6407440.8	108	315445.0	6408206.2
9	316871.1	6407451.4	109	315553.6	6408228.7
10	317314.2	6407667.8	110	315690.8	6408216.3
11	317488.3	6407804.2	111	315886.3	6408171.8
12	317476.72	6407568.73	112	316089.5	6408083.7
13	317549.3	6406668.7	113	316377.2	6408006.9
14	317492.6	6406273.3	114	316513.6	6409968.6
15	317489.8	6406253.4	115	317037.5	6409947.6
16	317407.5	6405674.9	116	317039.9	6409927.3
17	317216.6	6405702.1	117	317090.5	6409946.7
18	317191.4	6405753.8	118	317127.9	6409906.0
19	316783.3	6405555.5	119	31751.2	6409018.6
20	316750.9	6405538.6	120	31754.3	6409979.4
21	316159.8	6405250.0	121	317144.0	6408805.8
22	316138.1	6405239.3	122	317165.0	6408726.8
23	315671.7	6405011.6	123	317243.1	6408463.7
24	315777.6	6405613.8	124	317286.9	6408419.7
25	315761.3	6405646.2	125	317349.2	6408349.7
26	315718.5	6405733.8	126	317375.9	6408250.2
27	315708.4	6405755.2	127	317381.8	6408133.7
28	315666.9	6406593.6	128	317380.1	6408095.9
29	315186.8	6406590.9	129	317401.0	6407948.6
30	315903.7	6406492.7	130	317418.9	6407905.3
31	315923.7	6406490.0	131	314807.7	6408221.8
32	316303.5	6406437.5	132	316034.5	6408158.1
33	316702.7	6406381.8	133	315030.8	6408193.5
34	316722.58	6406379.06	134	315128.4	6408162.3
35	316719.8	6406359.2	135	315230.6	6408137.0
36	316699.9	6406361.9	136	315328.8	6408105.4
37	316300.7	6406417.6	137	315375.2	6407923.4
38	315920.9	6406447.1	138	315389.6	6407770.0
39	315900.9	6406472.8	139	315947.8	6406748.1
40	315851.6	6406570.8	140	315617.6	6406448.2
41	315164.1	6406573.7	141	315644.7	6406228.6
42	315167.4	6405747.8	142	315797.7	6406151.8
43	315388.8	6405744.9	143	315924.0	6406126.3
44	315793.8	6405690.8	144	315973.4	6406138.6
45	315813.8	6405688.1	145	316037.8	6406124.4
46	316592.3	6405580.8	146	316149.7	6406118.9
47	316612.2	6405578.0	147	316245.4	6406110.4
48	316209.9	6405613.2	148	316393.9	6408094.7
49	316190.0	6405615.9	149	316499.0	6408075.6
50	315392.9	6405724.1	150	316559.6	6406084.0
51	315722.9	6405726.8	151	316662.9	6405788.3
52	314323.0	6406690.1	152	316716.0	6406227.0
53	314738.9	6405830.3	153	316807.3	6406150.3
54	314743.2	6405809.4	154	316886.7	6406351.8
55	314859.0	6404855.6	155	316946.9	6406270.8
56	315245.1	6404802.2	156	316982.8	6406208.2
57	315171.5	6404123.7	157	317006.6	6406157.4
58	315280.2	6404909.4	158	317019.6	6406089.4
59	315282.9	6404929.3	159	317032.9	6406092.0
60	316080.7	6404819.2	160	317035.4	6409967.8
61	316100.1	6404816.5	161	316517.5	6409988.6
62	316097.3	6404796.5	162	316382.8	6406036.2
63	316077.4	6404799.3	163	316091.3	6406102.9
64	315986.4	6403991.8	164	315886.8	6406109.1
65	315964.0	6403976.2	165	315694.1	6406236.2
66	315925.5	6403975.3	166	315512.4	6406242.4
67	315936.9	6403879.6	167	315437.9	6406225.2
68	315957.4	6403887.8	168	315257.9	6406244.8
69	315921.9	6403922.6	169	315027.7	6406104.5
70	316034.5	6404000.6	170	314667.9	6406157.9
71	316022.4	6404066.7	171	315008.3	6406179.2
72	316022.2	6404041.4	172	314746.7	6406204.6
73	316222.4	6404295.4	173	314569.9	6406205.7
74	316022.4	6404271.2	174	314542.3	6406520.1
75	316113.6	6404289.5	175	313913.9	6406048.9
76	316007.1	6404388.6	176	313875.2	6406304.6
77	315693.3	6404038.6	177	314576.0	6406208.8
78	316706.7	6404510.9	178	314629.1	6406252.6
79	316706.7	6404510.9	179	314625.5	6406252.6
80	316577.0	6404555.4	180	314775.2	6406980.2
81	316471.6	6404711.4	181	314788.1	6406227.4
82	316670.0	6404737.9	182	314624.5	6406274.8
83	316668.1	6404762.6	183	314570.0	6406229.9
84	316718.8	6405056.1	184	313785.3	6406137.1
85	316693.3	6405099.1	185	313957.7	6406107.9
86	316693.3	6405099.1	186	313957.6	6406107.9
87	317298.4	6405481.8	187	314540.4	6406171.8
88	317144.7	6405418.2	188	31436.3	6406955.4
89	314546.6	6406679.6	189	314281.9	6406920.5
90	314563.6	6406609.9	190	314257.2	6406252.4
91	314384.5	6407278.8	191	314256.6	6406272.8
92	314429.3	6407515.8	192	314224.1	6406170.2
93	314429.3	6407515.8	193	314224.1	6406170.2
94	315380.0	6408231.4	194	314266.7	6406271.4
95	315399.9	6408202.3	195	314267.3	6406251.0
96	31611.3	6408007.1	196	314291.8	6406263.1
97	316134.2	6408004.3	197	314328.5	6409952.3
98	316191.4	6407907.2	198	314264.6	6406062.6
99	316933.8	6407903.5	199	314266.1	6406024.3
100	317466.8	6407878.3	200	315741.2	6406122.1
			201	315674.8	6406126.8
			202	315642.4	6406156.8

Schedule 2 – ML 1349

Mining Lease Conditions 2021

(Version 1.1 as at February 2022)

Definitions

Words used in this mining lease have the same meaning as defined in the *Mining Act 1992* except where otherwise defined below:

Term	Definition
Act	means the <i>Mining Act 1992</i> .
Landholder	for the purposes of these conditions: <ul style="list-style-type: none">• does not include a secondary landholder• includes, in the case of exempted areas, the controlling body for the exempted area.
Minister	means the Minister administering the Act.

Note:

1. The rights and duties of the Lease Holder(s) are those prescribed by the *Mining Act 1992* and the Mining Regulation 2016, subject to the terms and conditions of this mining lease.
2. This mining lease does not override any obligation on the lease holder(s) to comply with the requirements of other legislation and regulatory instruments which may apply (including all relevant development approvals) unless specifically provided under the *Mining Act 1992* or other legislation or regulatory instruments.

Standard conditions

See Mining Regulation 2016, Schedule 8A, Part 2.

NOTE TO HOLDERS: The prescribed standard conditions in the Mining Regulation 2016, Schedule 8A, Part 2 apply in addition to the conditions in this Schedule 2 (but have not been replicated in this mining lease). The conditions imposed by the Mining Regulation 2016 prevail to the extent of any inconsistency with the conditions in this Schedule 2.

General conditions

1. Notice to Landholders

- (a) Within 90 days from the date of grant or renewal of this mining lease, the lease holder must give each landholder notice in writing:
 - (i) that this mining lease has been granted or renewed; and
 - (ii) whether the lease includes the surface.

The notice must include a plan identifying the lease area and each landholder and individual land parcel within the lease area.

- (b) If there are ten or more landholders to which notice must be given, the lease holder will be taken to have complied with condition 1(a) if a notice complying with condition 1(a) is published in a newspaper circulating in the region where the lease area is situated.

2. Group Security

The lease holder is required to provide and maintain a security deposit to secure funding for the fulfilment of obligations under the mining leases covered by the group security deposit, including obligations under each mining lease that may arise in the future.

The amount to be provided and maintained as a group security deposit is **\$317,400**.

The leases covered by the group security include:

Mining Lease 1348 (Act 1992) (Head Lease)
Mining Lease 1349 (Act 1992) (This Lease)
Mining Lease 1580 (Act 1992)
Mining Lease 1667 (Act 1992)
Mining Lease 1668 (Act 1992)

3. Cooperation Agreement

The lease holder must make every reasonable attempt and be able to demonstrate its attempts to the satisfaction of the Secretary, to enter into a cooperation agreement with the holder(s) of any overlapping authorisations issued under the *Mining Act 1992* and petroleum titles issued under the *Petroleum (Onshore) Act 1992*. The cooperation agreement should address but not be limited to:

- access arrangements
- operational interaction procedures
- dispute resolution
- information exchange
- well location
- timing of drilling
- potential resource extraction conflicts; and
- rehabilitation issues.

4. Assessable Prospecting Operations

- (a) The lease holder must not carry out any assessable prospecting operation on land over which this lease has been granted unless:
 - (i) it is carried out in accordance with any necessary development consent; or
 - (ii) if development consent is not required, the prior written approval of the Minister has been obtained.
- (b) The Minister may require the lease holder to provide such information as required to assist the Minister to consider an application for approval.
- (c) An approval granted by the Minister under this condition may be granted subject to terms.
- (d) The lease holder must comply with the approval granted to the holder under this condition.

Special conditions

5. Dam Safety – Mining Leases

- (a) The lease holder must not mine within any part of the lease area which is within the notification area of the **Ravensthorpe Inpit Storage Dam, Ravensthorpe Void 4 East Tailings Dam, Ravensthorpe Void 5 Ash Dam** and **Ravensthorpe South Tailings Dam** without the prior written approval of the Minister and subject to any conditions the Minister may stipulate.
- (b) Where the lease holder desires to mine within the notification area, the lease holder must:
 - (i) at least twelve (12) months before mining is to commence or such lesser time as the Minister may permit, notify the Minister of the desire to do so. A plan of the mining system to be implemented must accompany the notice; and
 - (ii) provide such information as the Minister may direct.
- (c) The Minister must not, except in the circumstances set out in sub-paragraph (ii), grant approval unless sub-paragraph (i) of this paragraph has been complied with.
 - (i) This sub-paragraph is complied with if:
 - (a) Dams Safety NSW as constituted by section 6 of the *Dams Safety Act 2015* and the owner of the dam have been notified in writing of the desire to mine referred to in paragraph (b).
 - (b) the notifications referred to in clause (a) are accompanied by a description or plan of the area to be mined.
 - (c) the Secretary has complied with any reasonable request made by Dams Safety NSW or the owner of the dam for further information in connection with the mining proposal.
 - (d) Dams Safety NSW has made its recommendations concerning the mining proposal or has informed the Minister in writing that it does not propose to make any such recommendations; and
 - (e) where Dams Safety NSW has made recommendations the approval is in terms that are:
 - in accordance with those recommendations; or
 - where the Minister does not accept those recommendations or any of them - in accordance with a determination under sub-paragraph (ii) of this paragraph.
 - (ii) Where the Minister does not accept the recommendations of Dams Safety NSW or where Dams Safety NSW has failed to make any recommendations and has not informed the Minister in writing that it does not propose to make any recommendations, the approval shall be in terms that are, in relation to matters dealing with the safety of the dam:
 - as determined by agreement between the Minister and the Minister administering the *Dams Safety Act 2015*; or
 - in the event of failure to reach such agreement - as determined by the Premier.

- (d) The Minister, on notice from Dams Safety NSW, may at any time or times:
 - (i) cancel any approval given where a notice pursuant to section 19 of the *Dams Safety Act 2015* is given.
 - (ii) suspend for a period of time, alter, omit from or add to any approval given or conditions imposed.

Exploration Reporting

Note: Exploration Reports (Geological and Geophysical)

The lease holder must lodge reports in accordance with the requirements in section 163C of the *Mining Act 1992* and clauses 59, 60 and 61 of the Mining Regulation 2016 as well as any further requirements issued by the Secretary under clause 62 of the Mining Regulation 2016.

Guidelines for the structure, content and data format requirements for reports are set out in the *Exploration Reporting: A guide for reporting on exploration and prospecting in New South Wales*.

Schedule 1 – ML 1835

Description of Lease

Land: The lease area embraces all land described in the attached lease plan titled **M27609** and approved on **23 November 2022**.

Area: 404.6 hectares

**Surface Exception /
Depth Restriction:** Embraces the coal only from a depth of 15 metres above the roof of the seam known in the Department of Regional NSW as the Pikes Gully Seam to a depth of 10 metres below the floor of the seam known in the Department of Regional NSW as the Middle Liddell Seam

Minerals: Coal

Method: Underground methods

Term ending: 31 December 2044**

** Note: Current term expires on 31 December 2023. Determined renewal term will take effect 1 January 2024, with an expiry date of 31 December 2044.

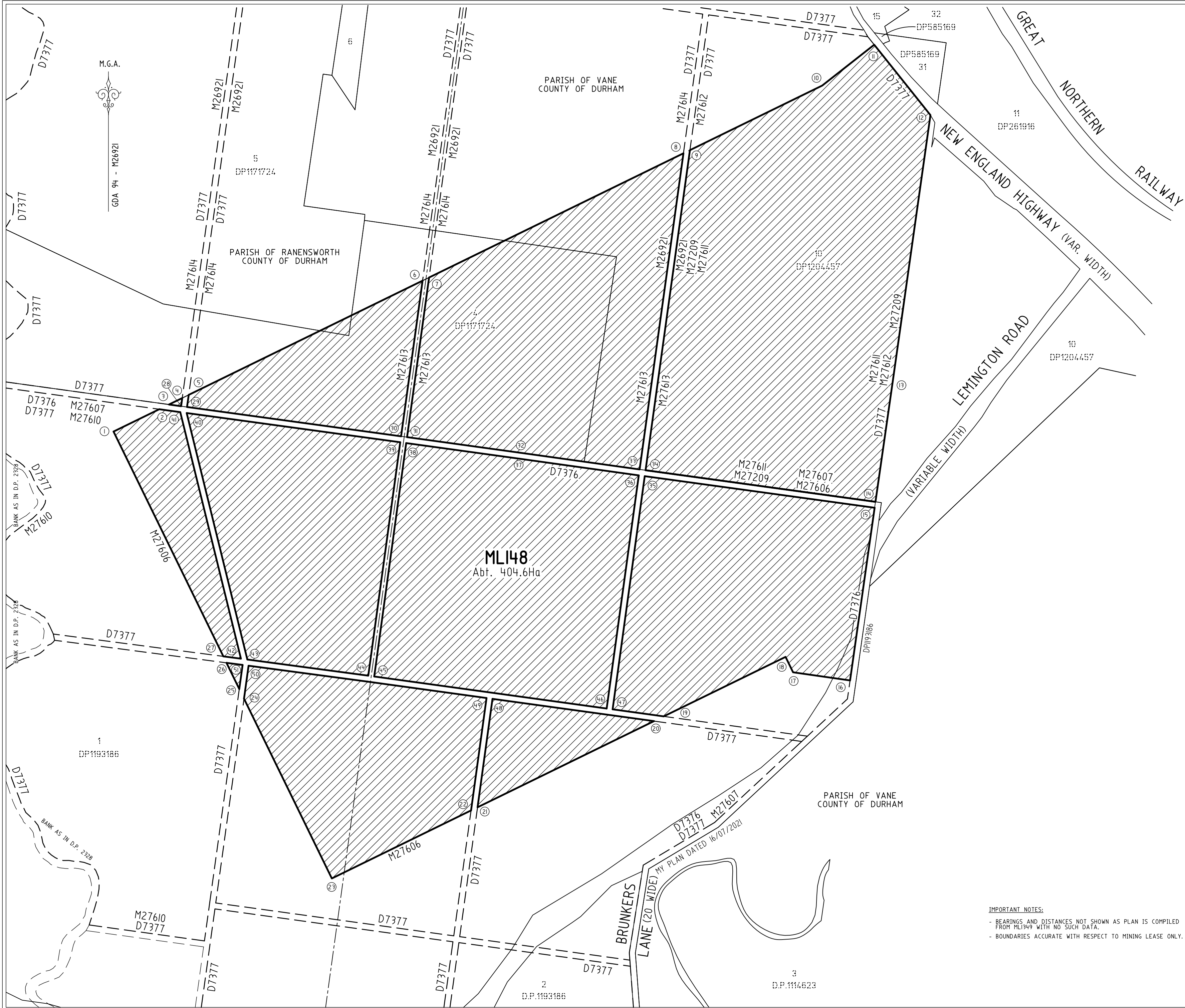

PLAN OF PORTION ML148

PARISH: RAVENSWOTH & VANE

COUNTY: DURHAM

MAP SHEET No. 9133-3-S

REDUCTION RATIO 1:6,000

MINING LEASE PART TRANSFER OF
ML 1349 (Act 1992) Dealing No. 38

MINING DIVISION: SINGLETON

TRANSFEREE: WHITE MINING (NSW) PTY
LIMITED

APPLICATION DATE: 29-AUG-2022

MINING LEASE No. (Act 1992)

STATUS:

METHOD: UNDERGROUND

SURFACE EXCEPTION / DEPTH RESTRICTION

EMBRACES THE COAL ONLY FROM A DEPTH OF 15 METRES
ABOVE THE ROOF OF THE SEAM KNOWN IN THE DEPARTMENT
OF REGIONAL NSW AS THE PIKES GULLY SEAM TO A DEPTH OF
10 METRES BELOW THE FLOOR OF THE SEAM KNOWN IN THE
DEPARTMENT OF REGIONAL NSW AS THE MIDDLE LIDDELL
SEAM.

NOTES:

Azimuth: M26921

Plans used in the course of this Survey/Compilation

M26921, M27209, D158, M27606, M27607, M27610,
M27611, M27612, M27613, M27614 &
987-1557, DP2328, DP636424, DP1048492, DP193186
MY PLAN HUNTER RIVER AD MEDIUM FILUM AQUAE
DATED 16/07/2021

Survey declared on this plan for lines

I Martin Alexander Burns
of Survey and Drafting Resources Pty.Ltd.

a surveyor registered under the Surveying and Spatial
Information Act 2002, hereby certify that the compilation
represented in this plan is accurate and
has been completed in accordance with the Surveying
and Spatial Information Regulation 2017 and the
Surveyor General's Direction for Mining Surveys and
was completed on 25/10/2022

Signature :
BOSSI Identification No : 263

Survey Calcs : F. Schiavo 22/11/2022
Plan Investigated : F. Schiavo 22/11/2022
Plan Approved : W. McDonald 23/11/2022
Papers No.: PTF-2022-10 SURVEY-32 R00033437
D006242820

IMPORTANT NOTES:
- BEARINGS AND DISTANCES NOT SHOWN AS PLAN IS COMPILED
FROM ML1349 WITH NO SUCH DATA.
- BOUNDARIES ACCURATE WITH RESPECT TO MINING LEASE ONLY.

M27609

PLAN OF PORTION ML148
ADMINISTRATIVE SHEET

PARISH: RAVENSWOTH & VANE

COUNTY: DURHAM

MAP SHEET No. 9133-3-S

REDUCTION RATIO 1:6,000

MINING LEASE PART TRANSFER OF
ML 1349 (Act 1992) Dealing No. 38

MINING DIVISION: SINGLETON

TRANSFEREE: WHITE MINING (NSW) PTY
LIMITED

APPLICATION DATE: 29-AUG-2022

MINING LEASE No. (Act 1992)

STATUS:

METHOD: UNDERGROUND

SURFACE EXCEPTION / DEPTH RESTRICTION

NOTES:

Azimuth: M26921

Plans used in the course of this Survey/Compilation

M26921, M27209, D1158, M27606, M27607, M27610, ...
M27611, M27612, M27613, M27614, &
987-1557, DP2328, DP636424, DP1048492, DP193186
MY PLAN HUNTER RIVER - AD MEDIUM FILUM AQUAE
DATED 16/07/2021

Survey declared on this plan for lines

I Martin Alexander Burns
of Survey and Drafting Resources Pty.Ltd.
a surveyor registered under the Surveying and Spatial
Information Act 2002, hereby certify that the compilation
represented in this plan is accurate and
has been completed in accordance with the Surveying
and Spatial Information Regulation 2017 and the
Surveyor General's Direction for Mining Surveys and
was completed on 25/10/2022

Signature : [Signature]

BOSSI Identification No : 263

Survey Calcs : [Signature], F. Schiavo 22/11/2022

Plan Investigated : [Signature], F. Schiavo 22/11/2022

Plan Approved : W. McDonald 23/11/2022

Papers No.: PTF-2022-10 SURVEY-32 R00033437
D006242750

CO-ORDINATE TABLE
(M.G.A. ZONE 56 GDA94)

No.	EASTING	NORTHING
1	314940.1	6406507.2
2	315093.3	6406582.0
3	315125.7	6406597.8
4	315170.2	6406619.6
5	315192.0	6406630.2
6	315975.2	6407012.7
7	315997.1	6407023.4
8	316848.9	6407439.4
9	316870.6	6407450.0
10	317313.7	6407666.4
11	317487.8	6407803.2
12	317676.24	6407567.34
13	317548.8	6406667.3
14	317492.1	6406271.9
15	317489.3	6406252.0
16	317407.0	6405673.5
17	317216.2	6405700.7
18	317190.9	6405752.4
19	316782.8	6405553.1
20	316750.4	6405537.2
21	316159.3	6405248.6
22	316137.6	6405237.9
23	315671.3	6405010.2
24	315377.1	6405612.4
25	315361.3	6405644.8
26	315318.5	6405732.5
27	315307.9	6405754.1
28	315166.4	6406592.2
29	315186.3	6406589.5
30	315903.2	6406491.3
31	315923.2	6406488.6
32	316303.0	6406436.1
33	316702.2	6406380.4
34	316722.10	6406377.67
35	316719.4	6406357.8
36	316699.4	6406360.5
37	316300.2	6406416.2
38	315920.4	6406468.7
39	315900.5	6406471.4
40	315185.1	6406569.4
41	315163.7	6406572.3
42	315366.9	6405746.4
43	315388.3	6405743.6
44	315793.4	6405689.5
45	315813.3	6405686.7
46	316591.8	6405579.4
47	316611.7	6405576.7
48	316209.4	6405611.8
49	316189.5	6405614.5
50	315392.4	6405722.7
51	315372.5	6405725.4

CO-ORDINATE TABLE
(M.G.A. ZONE 56 GDA2020)

No.	EASTING	NORTHING
1	314940.6	6406508.6
2	315093.8	6406583.4
3	315126.2	6406599.2
4	315170.7	6406621.0
5	315192.5	6406631.6
6	315975.7	6407014.1
7	315997.6	6407024.8
8	316849.4	6407440.8
9	316871.1	6407451.4
10	317314.2	6407667.8
11	317488.3	6407804.6
12	317676.72	6407568.73
13	317549.3	6406668.7
14	317492.6	6406273.3
15	317489.8	6406253.4
16	317407.5	6405674.9
17	317216.6	6405702.1
18	317191.4	6405753.8
19	316783.3	6405554.5
20	316750.9	6405538.6
21	316159.8	6405250.0
22	316138.1	6405239.3
23	315671.7	6405011.6
24	315377.6	6405613.8
25	315361.8	6405646.2
26	315319.0	6405733.8
27	315308.4	6405755.5
28	315166.9	6406593.6
29	315186.8	6406590.9
30	315903.7	6406492.7
31	315923.7	6406490.0
32	316303.5	6406437.5
33	316702.7	6406381.8
34	316722.58	6406379.06
35	316719.8	6406359.2
36	316699.9	6406361.9
37	316300.7	6406417.6
38	315920.9	6406470.1
39	315900.9	6406472.8
40	315185.6	6406570.8
41	315164.1	6406573.7
42	315367.4	6405747.8
43	315388.8	6405744.9
44	315793.8	6405690.8
45	315813.8	6405688.1
46	316592.3	6405580.8
47	316612.2	6405578.0
48	316209.9	6405613.2
49	316190.0	6405615.9
50	315392.9	6405724.1
51	315372.9	6405726.8

CO-ORDINATES 9-14 & 34 COMPILED FROM M27XXa
CO-ORDINATES 4-8 & 28-31 & 33 COMPILED FROM M27XXc
CO-ORDINATES 1-2 & 15-32 & 34-51 COMPILED FROM M27XXe

FORM11

M27609

Schedule 2 – ML 1835

Mining Lease Conditions 2021

(Version 1.1 as at February 2022)

Definitions

Words used in this mining lease have the same meaning as defined in the *Mining Act 1992* except where otherwise defined below:

Term	Definition
Act	means the <i>Mining Act 1992</i> .
Landholder	for the purposes of these conditions: <ul style="list-style-type: none">• does not include a secondary landholder• includes, in the case of exempted areas, the controlling body for the exempted area.
Minister	means the Minister administering the Act.

Note:

3. The rights and duties of the Lease Holder(s) are those prescribed by the *Mining Act 1992* and the Mining Regulation 2016, subject to the terms and conditions of this mining lease.
4. This mining lease does not override any obligation on the lease holder(s) to comply with the requirements of other legislation and regulatory instruments which may apply (including all relevant development approvals) unless specifically provided under the *Mining Act 1992* or other legislation or regulatory instruments.

Standard conditions

See Mining Regulation 2016, Schedule 8A, Part 2.

NOTE TO HOLDERS: The prescribed standard conditions in the Mining Regulation 2016, Schedule 8A, Part 2 apply in addition to the conditions in this Schedule 2 (but have not been replicated in this mining lease). The conditions imposed by the Mining Regulation 2016 prevail to the extent of any inconsistency with the conditions in this Schedule 2.

General conditions

1. Notice to Landholders

- (a) Within 90 days from the date of grant or renewal of this mining lease, the lease holder must give each landholder notice in writing:

- (i) that this mining lease has been granted or renewed; and
- (ii) whether the lease includes the surface.

The notice must include a plan identifying the lease area and each landholder and individual land parcel within the lease area.

- (b) If there are ten or more landholders to which notice must be given, the lease holder will be taken to have complied with condition 1(a) if a notice complying with condition 1(a) is published in a newspaper circulating in the region where the lease area is situated.

2. Security

The lease holder is required to provide and maintain a security deposit to secure funding for the fulfilment of obligations under the mining lease, including obligations under the mining lease that may arise in the future.

The amount of the security deposit to be provided and maintained is **\$10,000**.

3. Cooperation Agreement

The lease holder must make every reasonable attempt and be able to demonstrate its attempts to the satisfaction of the Secretary, to enter into a cooperation agreement with the holder(s) of any overlapping authorisations issued under the *Mining Act 1992* and petroleum titles issued under the *Petroleum (Onshore) Act 1992*. The cooperation agreement should address but not be limited to:

- access arrangements
- operational interaction procedures
- dispute resolution
- information exchange
- well location
- timing of drilling

- potential resource extraction conflicts; and
- rehabilitation issues.

4. Assessable Prospecting Operations

- (a) The lease holder must not carry out any assessable prospecting operation on land over which this lease has been granted unless:
 - (i) it is carried out in accordance with any necessary development consent; or
 - (ii) if development consent is not required, the prior written approval of the Minister has been obtained.
- (b) The Minister may require the lease holder to provide such information as required to assist the Minister to consider an application for approval.
- (c) An approval granted by the Minister under this condition may be granted subject to terms.
- (d) The lease holder must comply with the approval granted to the holder under this condition.

Special conditions

5. Dam Safety – Mining Leases

- (a) The lease holder must not mine within any part of the lease area which is within the notification area of the **Ravensworth Inpit Storage Dam** and the **Ravensworth Void 5 Ash Dam** without the prior written approval of the Minister and subject to any conditions the Minister may stipulate.
- (b) Where the lease holder desires to mine within the notification area, the lease holder must:
 - (i) at least twelve (12) months before mining is to commence or such lesser time as the Minister may permit, notify the Minister of the desire to do so. A plan of the mining system to be implemented must accompany the notice; and
 - (ii) provide such information as the Minister may direct.
- (c) The Minister must not, except in the circumstances set out in sub-paragraph (ii), grant approval unless sub-paragraph (i) of this paragraph has been complied with.
 - (ii) This sub-paragraph is complied with if:
 - (f) Dams Safety NSW as constituted by section 6 of the *Dams Safety Act 2015* and the owner of the dam have been notified in writing of the desire to mine referred to in paragraph (b).
 - (g) the notifications referred to in clause (a) are accompanied by a description or plan of the area to be mined.
 - (h) the Secretary has complied with any reasonable request made by Dams Safety NSW or the owner of the dam for further information in connection with the mining proposal.
 - (i) Dams Safety NSW has made its recommendations concerning the mining proposal or has informed the Minister in writing that it does not propose to make any such recommendations; and
 - (j) where Dams Safety NSW has made recommendations the approval is in terms that are:
 - in accordance with those recommendations; or
 - where the Minister does not accept those recommendations or any of them - in accordance with a determination under sub-paragraph (ii) of this paragraph.
 - (ii) Where the Minister does not accept the recommendations of Dams Safety NSW or where Dams Safety NSW has failed to make any recommendations and has not informed the Minister in writing that it does not propose to make any recommendations, the approval shall be in terms that are, in relation to matters dealing with the safety of the dam:
 - as determined by agreement between the Minister and the Minister administering the *Dams Safety Act 2015*; or
 - in the event of failure to reach such agreement - as determined by the Premier.

- (d) The Minister, on notice from Dams Safety NSW, may at any time or times:
 - (i) cancel any approval given where a notice pursuant to section 19 of the *Dams Safety Act 2015* is given.
 - (ii) suspend for a period of time, alter, omit from or add to any approval given or conditions imposed.

Exploration Reporting

Note: Exploration Reports (Geological and Geophysical)

The lease holder must lodge reports in accordance with the requirements in section 163C of the *Mining Act 1992* and clauses 59, 60 and 61 of the Mining Regulation 2016 as well as any further requirements issued by the Secretary under clause 62 of the Mining Regulation 2016.

Guidelines for the structure, content and data format requirements for reports are set out in the *Exploration Reporting: A guide for reporting on exploration and prospecting in New South Wales*.